

**AMP 2025**

# Boston Convention & Exhibit Center

**Advertising Opportunities In Public Space**

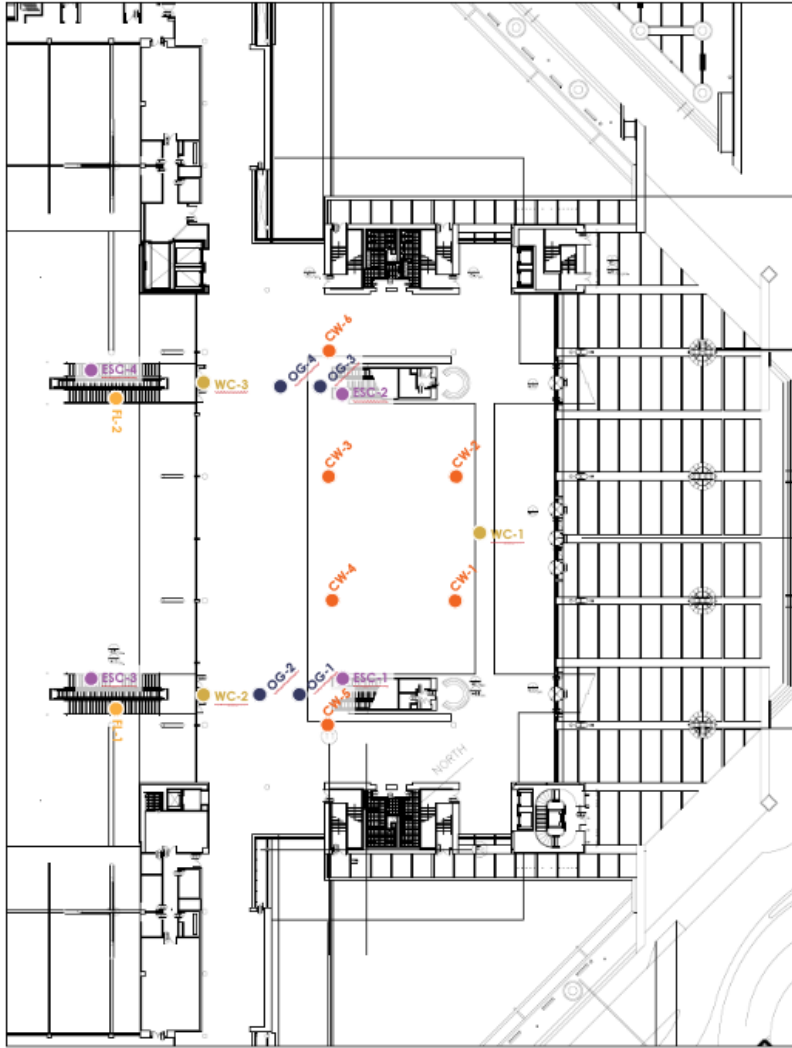



Opportunity	Description	Material	Qty.
CW-1 : Column Wrap	Size: 101.5"W x 84" H; Qty:1, Located: Front Left by Security Tables	Fabric Wrap	1
CW-2 : Column Wrap	Size: 101.75"W x 84" H; Qty:1, Located: Front Right by Security Tables	Fabric Wrap	1
CW-3 : Column Wrap	Size: 101.75"W x 84" H; Qty:1, Located: Middle Right of Lobby	Fabric Wrap	1
CW-4 : Column Wrap	Size: 101.5"W x 84" H; Qty:1, Located: Middle Left of Lobby	Fabric Wrap	1
CW-5 : Column Wrap	Size: 101.5"W x 84" H; Qty:1, Located: Left Escalators	Fabric Wrap	1
CW-6 : Column Wrap	Size: 101.5"W x 84" H; Qty:1, Located: Right Escalators	Fabric Wrap	1
OG-1 : Overhead Graphic	Size: 96"W x 36" H; Qty:1, Located: Front of Left Escalator	1" Foam	1
OG-2 : Overhead Graphic	Size: 96"W x 36" H; Qty:1, Located: Front of Left Escalator	1" Foam	1
OG-3 : Overhead Graphic	Size: 96"W x 36" H; Qty:1, Located: Front of Right Escalator	1" Foam	1
OG-4 : Overhead Graphic	Size: 96"W x 36" H; Qty:1, Located: Front of Right Escalator	1" Foam	1
ESC-1 : Escalator Cling	Size: (6) 74.75" W x 26.25" H Glass Panels, Shorter Panel at the top: 51.6.25"W x 26.25" H; Qty:4; Located: Left side of Level 1 Lobby	Wall Noodle	1
ESC-2 : Escalator Cling	Size: (6) 74.75" W x 26.25" H Glass Panels, Shorter Panel at the top: 51.6.25"W x 26.25" H; Qty:4; Located: Right side of Level 1 Lobby	Wall Noodle	1
ESC-3 : Escalator Cling	Size: (6) 74.75" W x 26.25" H Glass Panels, Shorter Panel at the top: 51.6.25"W x 26.25" H; Qty:4; Located: Left side of Level 0 Exhibit Hall A	Wall Noodle	1
ESC-4 : Escalator Cling	Size: (6) 74.75" W x 26.25" H Glass Panels, Shorter Panel at the top: 51.6.25"W x 26.25" H; Qty:4; Located: Right side of Level 0 Exhibit Hall A	Wall Noodle	1
FL-1 : Floor Graphic	Size 48" x 48" Vinyl Graphic, Qty: 2, One per staircase into Exhibit Hall A	Vinyl	2
WC-1 : Window Cling	Size: 40.75"H x 73.5" W, (12) 119.5"W, 73.5"W; Qty: 14; Located: Level 2 walkway	Wall Noodle	1
WC-2 : Window Cling	Size: Left: 113"W x 91 ¾"H, Right: 97"W x 91 ¾"H Qty:2, Level 1 Doors down to Exhibit Hall A	Wall Noodle	1
WC-3 : Window Cling	Size: Left: 96"W x 91 ¾"H, Right: 112 ¾"W x 91 ¾"H Qty:2, Level 1 Doors down to Exhibit Hall A	Wall Noodle	1
MB-1 : Meter Boards	Size: 39" x 89"; Qty: Various; Located: TBD	1" Foam	TBD
AS-1 : Aisle Sign Danglers	Size: Cannot Exceed 48" x 24" H, Qty: 1 per Aisle, Located: TBD	3/16" Foam	TBD
SK-1 : Spinning Kiosk	Size: 37-7/8"W x 92-13/16"H, Qty: 6, Located: TBD	37-7/8"W x 92-13/16"H	6

# Level 1 – Lobby

## CW-1 | Column Wrap

### SUGGESTED MATERIAL:

Fabric Wrap

### SUGGESTED SIZE:

101.5" W x 84" H

### MORE INFO:

QTY: 1

Single Sided

Price: \$6,000

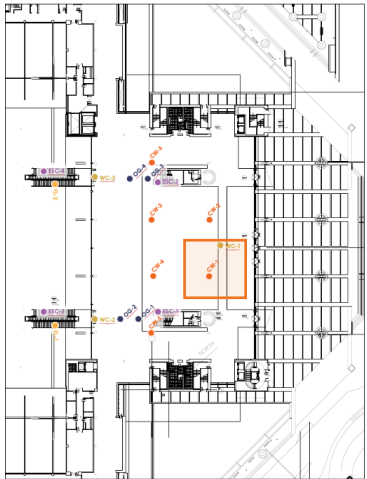

Verify graphic size  
before printing.



# Level 1 – Lobby

## CW-2 | Column Wrap

### SUGGESTED MATERIAL:

Fabric Wrap

### SUGGESTED SIZE:

101.75 " W x 84"H

### MORE INFO:

QTY: 1

Single Sided

Price: \$6,000

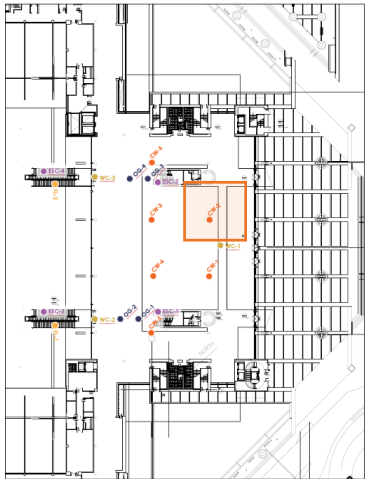

Verify graphic size  
before printing.

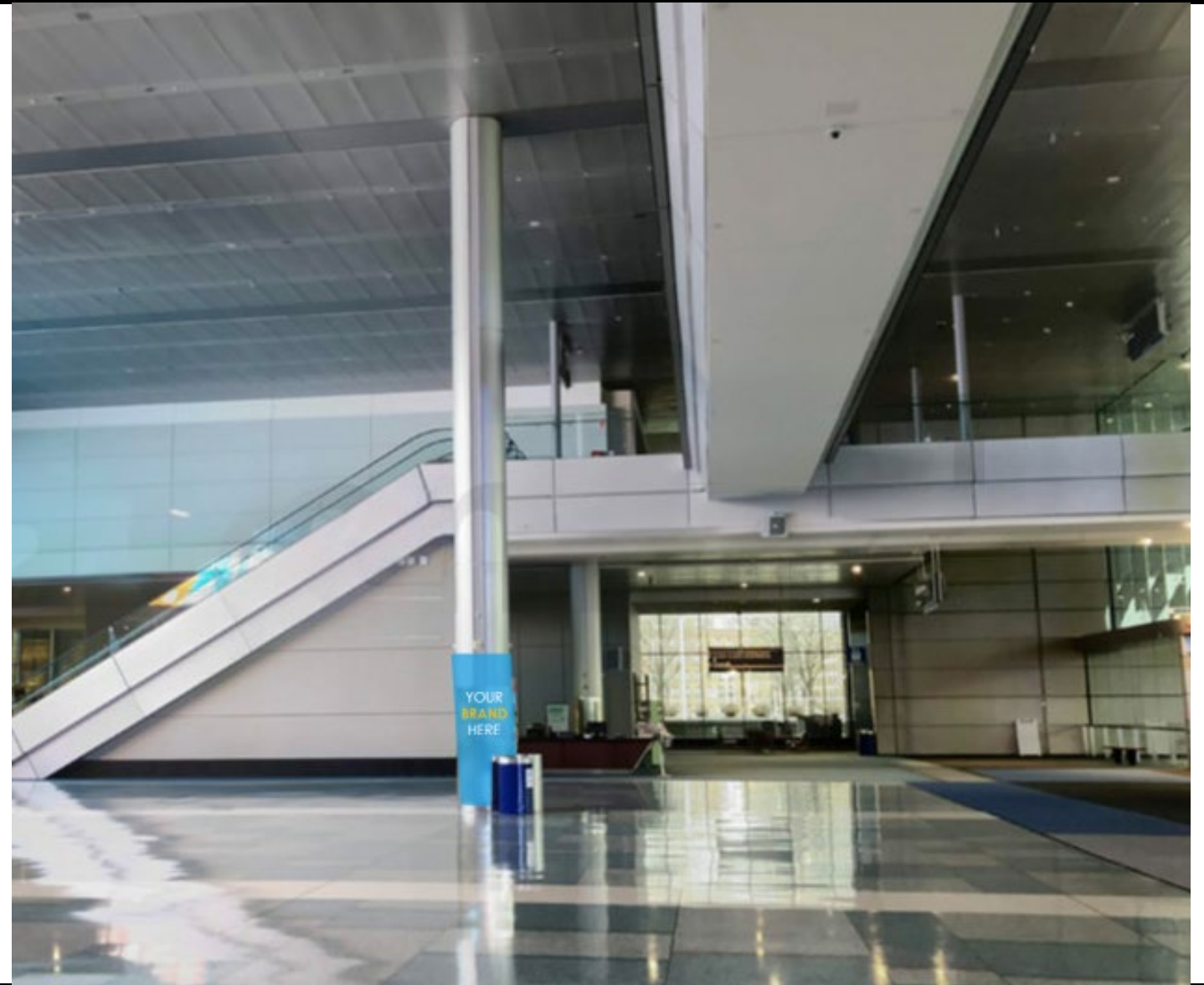

# Level 1 – Lobby

## CW-3 | Column Wrap

### SUGGESTED MATERIAL:

Fabric Wrap

### SUGGESTED SIZE:

101.75" W x 84"H

### MORE INFO:

QTY: 1

Single Sided

Price: \$6,000

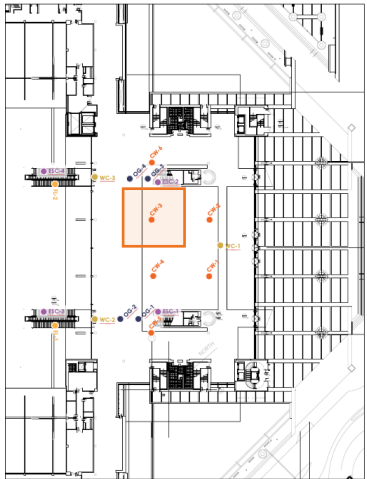

Verify graphic size  
before printing.



# Level 1 – Lobby

## CW-4 | Column Wrap

### SUGGESTED MATERIAL:

Fabric Wrap

### SUGGESTED SIZE:

101.5" W x 84"H

### MORE INFO:

QTY: 1

Single Sided

**Price: \$6,000**

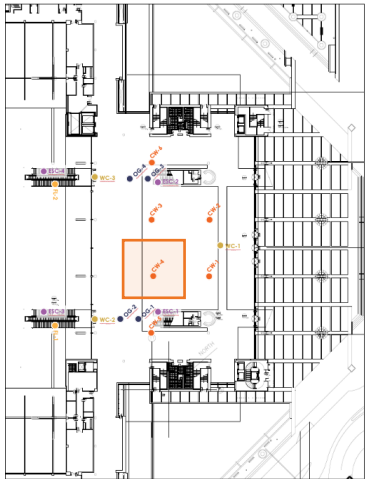

Verify graphic size  
before printing.



# Level 1 – Lobby

## CW-5 | Column Wrap

### SUGGESTED MATERIAL:

Fabric Wrap

### SUGGESTED SIZE:

101.5" W x 84"H

### MORE INFO:

QTY: 1

Single Sided

**Price: \$6,000**

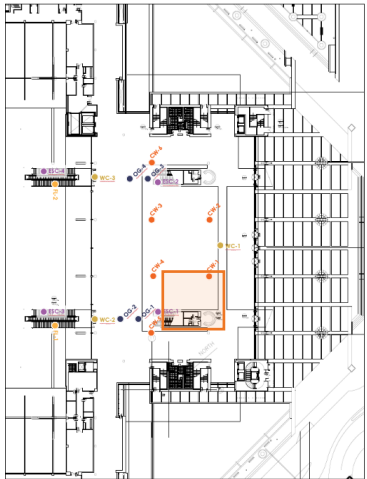

Verify graphic size  
before printing.



# Level 1 – Lobby

## CW-6 | Column Wrap

### SUGGESTED MATERIAL:

Fabric Wrap

### SUGGESTED SIZE:

101.5" W x 84"H

### MORE INFO:

QTY: 1

Single Sided

**Price: \$6,000**

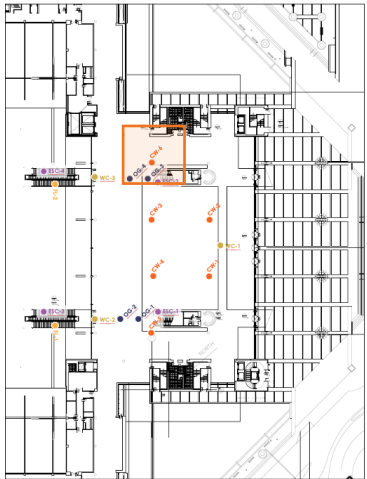

Verify graphic size  
before printing.





# Level 1 – Lobby

## OG-1 | Overhead Graphics

### SUGGESTED MATERIAL:

1" Foam

### SUGGESTED SIZE:

96" W x 36" H

### MORE INFO:

QTY: 1

Double Sided

Price: \$5,000

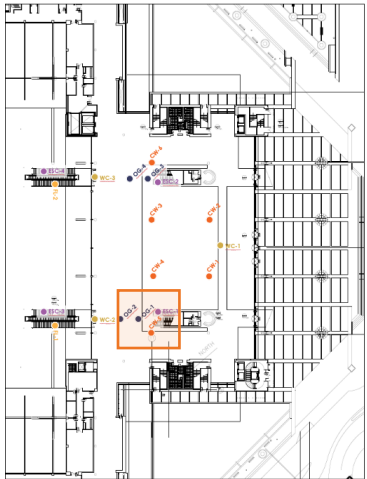

Verify graphic size  
before printing.



# Level 1 – Lobby

## OG-2 | Overhead Graphics

### SUGGESTED MATERIAL:

1" Foam

### SUGGESTED SIZE:

96" W x 36"H

### MORE INFO:

QTY: 1

Double Sided

Price: \$5,000

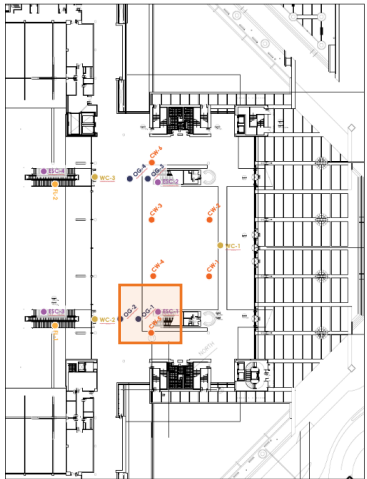

Verify graphic size  
before printing.

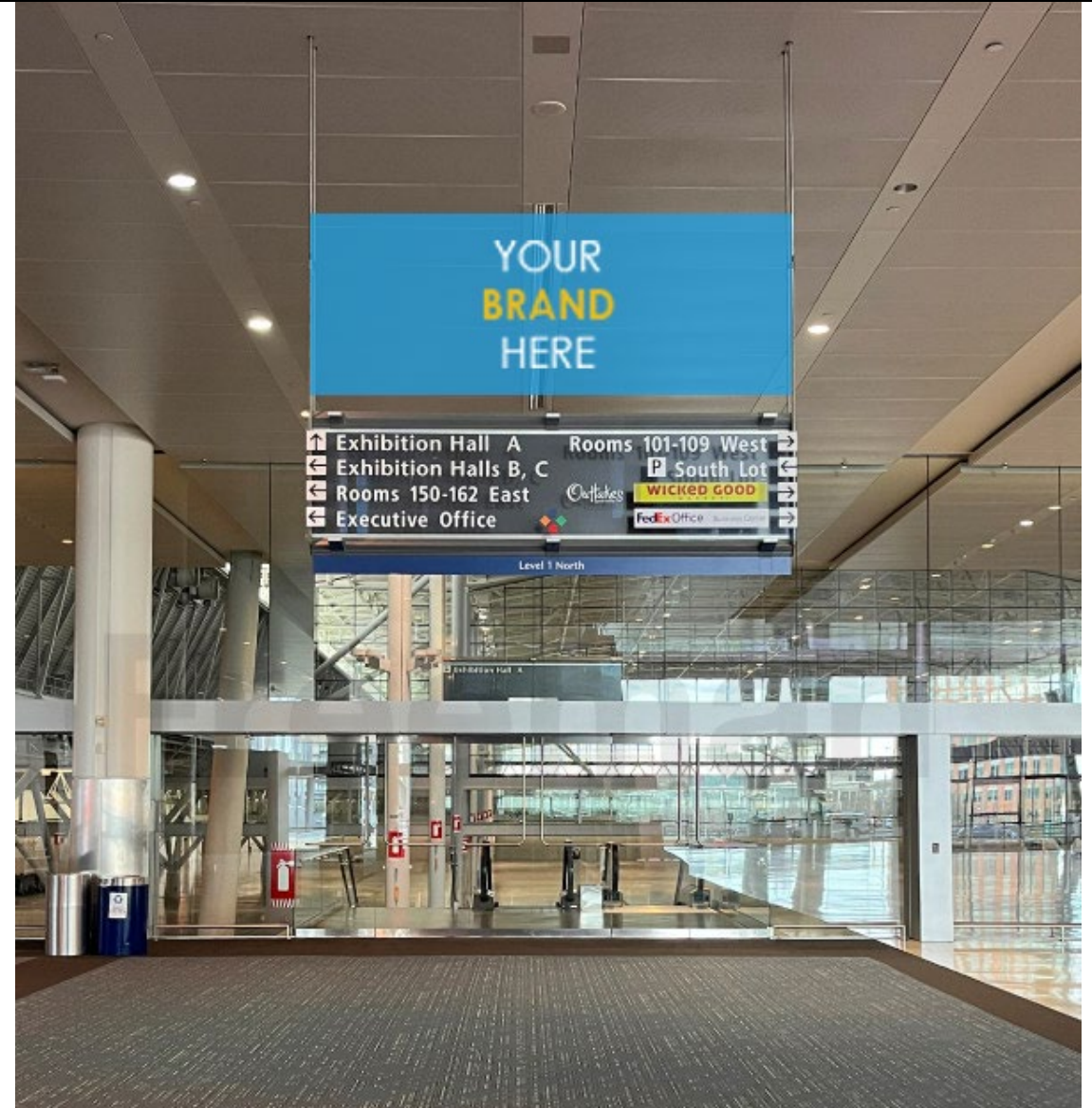

# Level 1 – Lobby

## OG-3 | Overhead Graphics

### SUGGESTED MATERIAL:

1" Foam

### SUGGESTED SIZE:

96" W x 36"H

### MORE INFO:

QTY: 1

Double Sided

Price: \$5,000

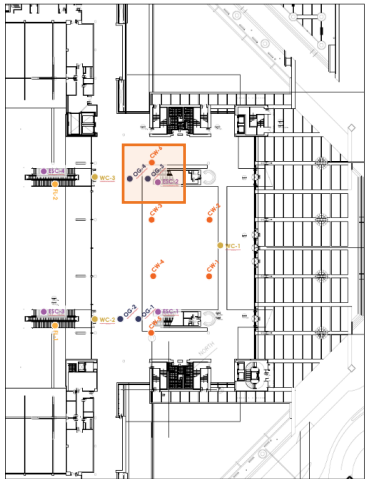

Verify graphic size  
before printing.

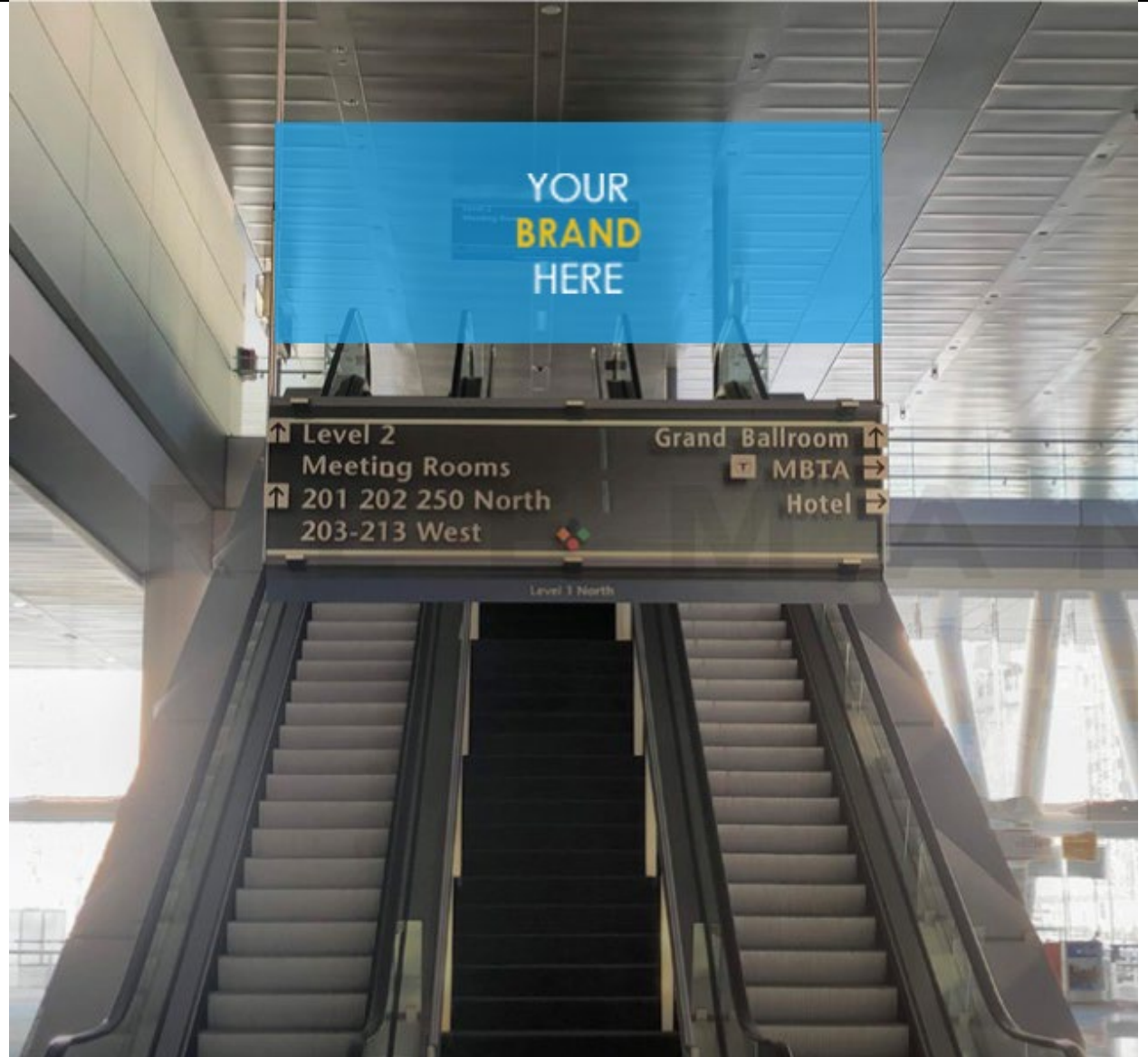

# Level 1 – Lobby

## OG-4 | Overhead Graphics

### SUGGESTED MATERIAL:

1" Foam

### SUGGESTED SIZE:

96" W x 36"H

### MORE INFO:

QTY: 1

Double Sided

Price: \$5,000

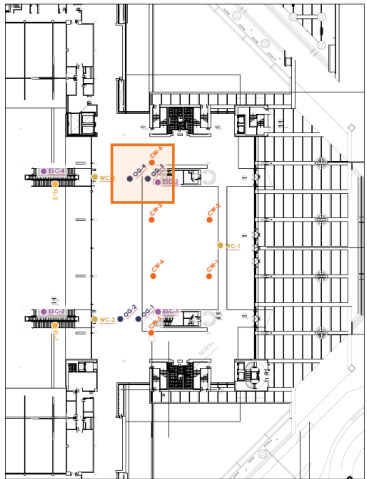

Verify graphic size  
before printing.

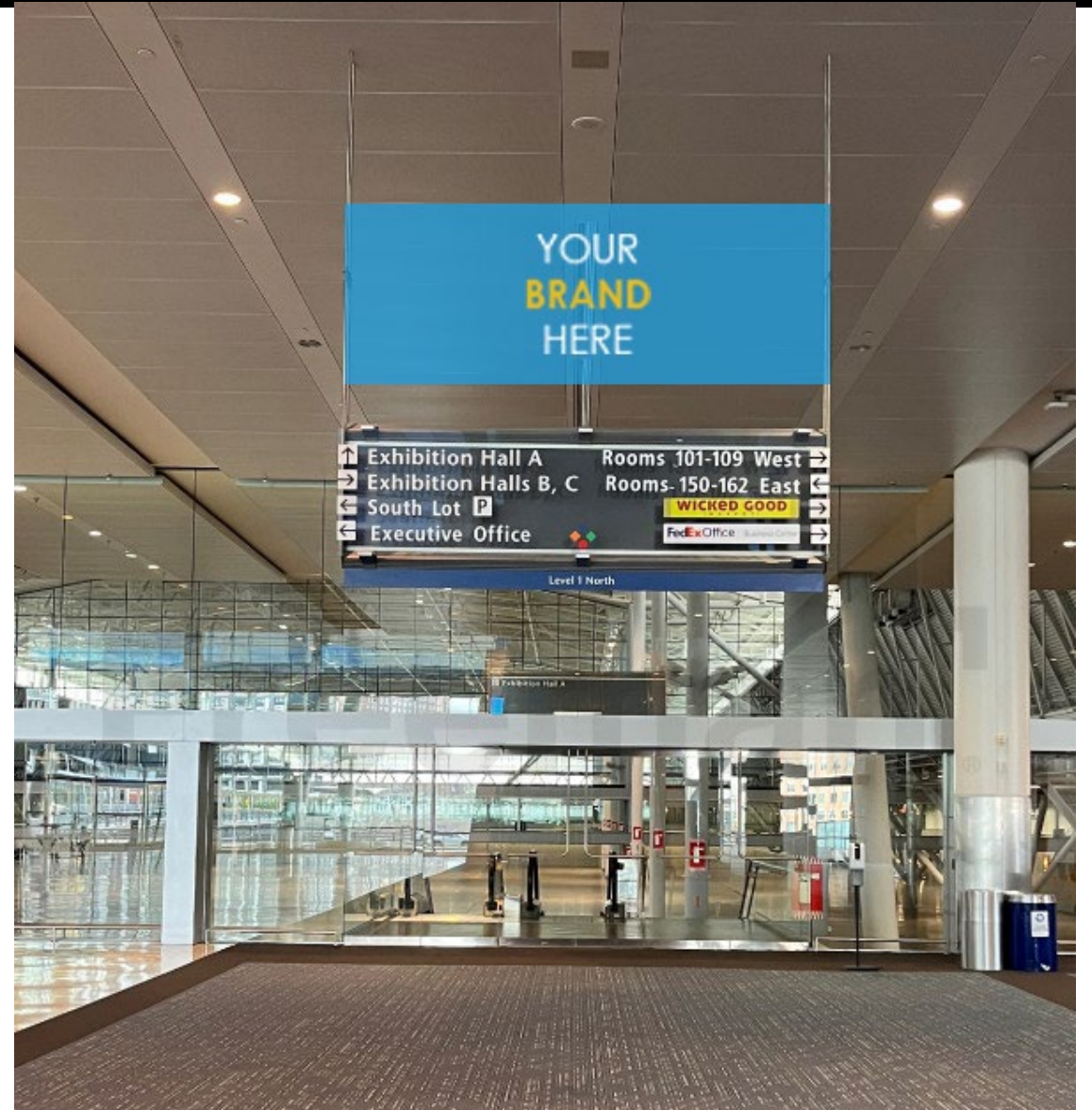

# Level 1 up to Level 2 – Escalators

## ESC-1 | Escalator Clings

### SUGGESTED MATERIAL:

Wall Noodle

### SUGGESTED SIZE:

(6) 74.75" W x 26.25" H Glass Panels

Shorter Panel at the top: 51.625"W x 26.25" H

### MORE INFO:

QTY: 1, Double Sided

**Price: \$15,000**

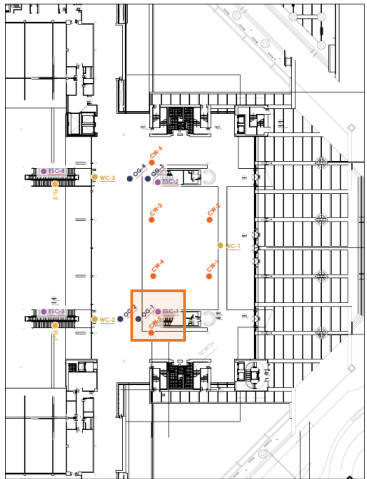

Verify graphic size  
before printing.



# Level 1 up to Level 2 – Escalators

## ESC-2 | Escalator Clings

### SUGGESTED MATERIAL:

Wall Noodle

### SUGGESTED SIZE:

(6) 74.75" W x 26.25" H Glass Panels

Shorter Panel at the top: 51.625"W x 26.25" H

### MORE INFO:

QTY: 1, Double Sided

Price: \$15,000

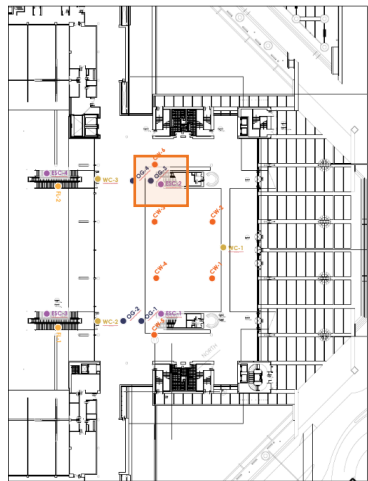

Verify graphic size  
before printing.



# Level 1 down to Exhibit Hall – Escalators

## ESC-3 | Escalator Clings

### SUGGESTED MATERIAL:

Wall Noodle

### SUGGESTED SIZE:

(6) 74.75" W x 26.25" H Glass Panels

Shorter Panel at the top: 51.6.25"W x 26.25" H

### MORE INFO:

QTY: 1, Double Sided

Price: \$15,000

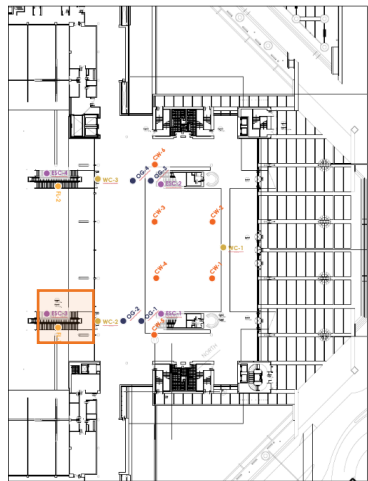

Verify graphic size  
before printing.

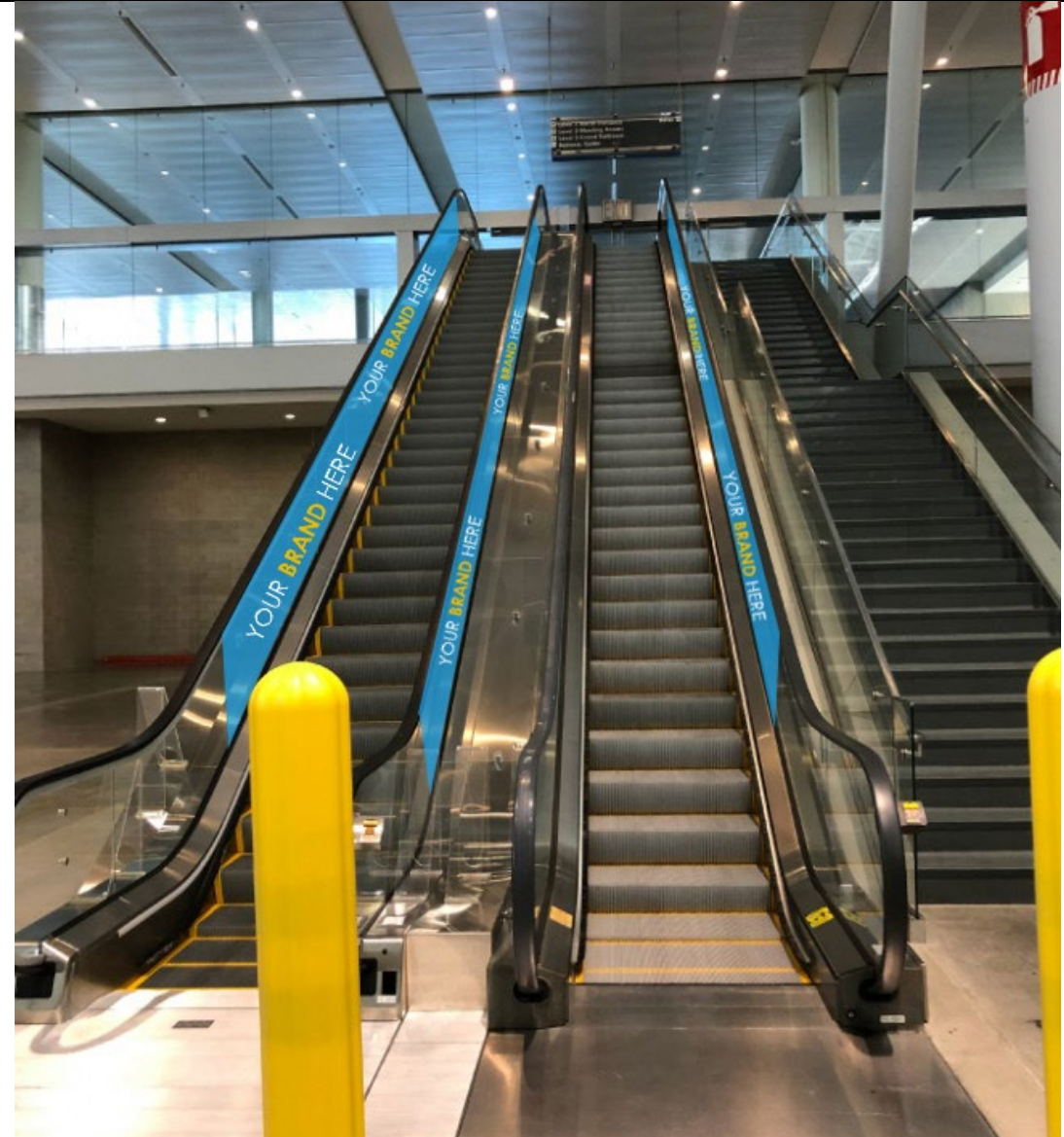

# Level 1 down to Exhibit Hall – Escalators

## ESC-4 | Escalator Clings

### SUGGESTED MATERIAL:

Wall Noodle

### SUGGESTED SIZE:

(6) 74.75" W x 26.25" H Glass Panels

Shorter Panel at the top: 51.6.25"W x 26.25" H

### MORE INFO:

QTY: 1, Double Sided

Price: \$15,000

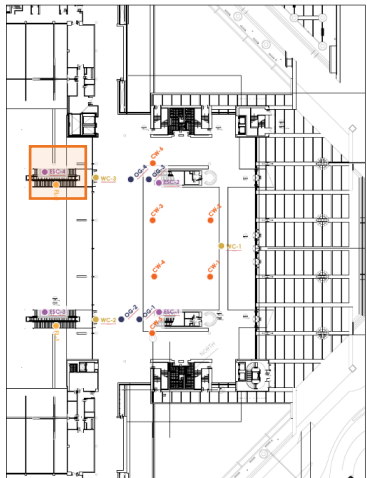

Verify graphic size  
before printing.

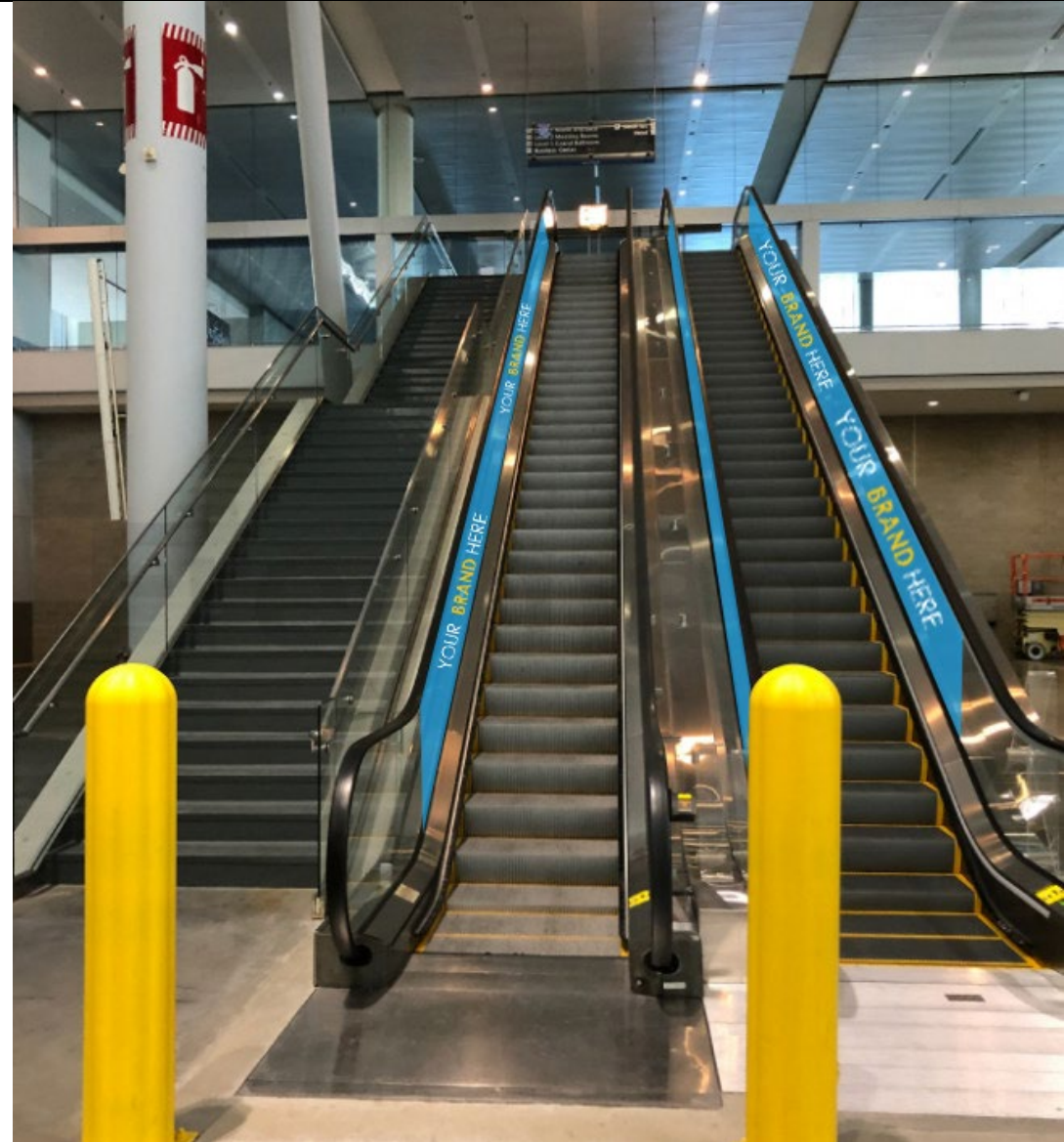



# Level 1 down to Exhibit Hall – Stairs

## FL-1 | Floor Graphic

### SUGGESTED MATERIAL:

Vinyl

### SUGGESTED SIZE:

48" x 48" on stair landings

### MORE INFO:

QTY: 2

Single Sided

Price: \$2,500 each

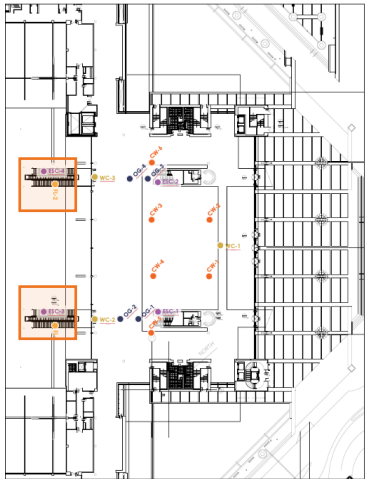

Verify graphic size  
before printing.



# Level 2 Walkway Above Level 1 Lobby

## WC-1 | Window Clings

### SUGGESTED MATERIAL:

Wall Noodle

### SUGGESTED SIZE:

40.75"H x 73.5" W, (12) 119.5"W, 73.5"W (14 total)

### MORE INFO:

QTY: 14

Double Sided

Price: \$20,000 for all

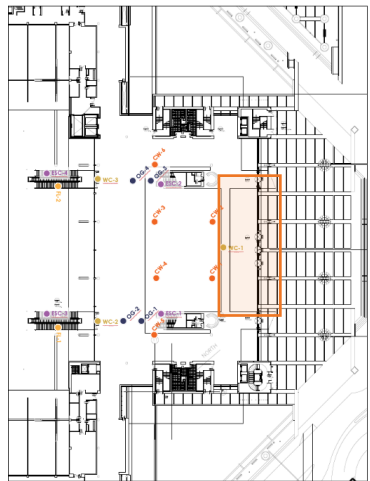

Verify graphic size  
before printing.



# Level 1 Left Outside Windows

## WC-2 | Window Clings

### SUGGESTED MATERIAL:

Wall Noodle

### SUGGESTED SIZE:

Left Window: 113"W x 91 ¾" H

Right Window: 97"W x 91 ¾" H

### MORE INFO:

QTY: 1, Double Sided

Price: \$10,000

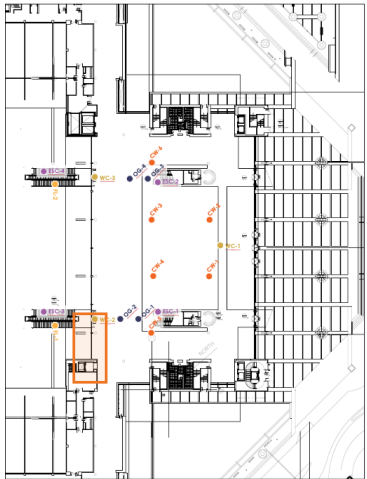

Verify graphic size  
before printing.



# Level 1 Right Outside Windows

## WC-3 | Window Clings

### SUGGESTED MATERIAL:

Wall Noodle

### SUGGESTED SIZE:

Left Window: 96"W x 91 ¾" H

Right Window: 112 ¾"W x 91 ¾" H

### MORE INFO:

QTY: 1, Double Sided

Price: \$10,000

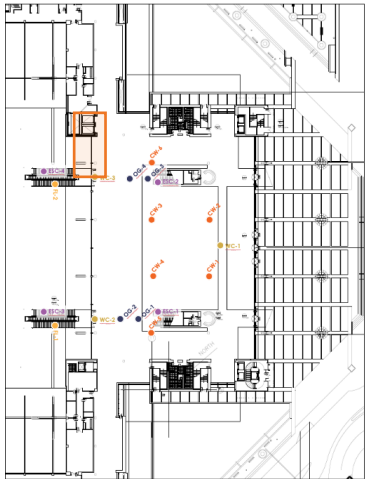

Verify graphic size  
before printing.



# All Levels

## MB-1 | Meter Boards

### SUGGESTED MATERIAL:

1" Foam

### SUGGESTED SIZE:

39"W x 89"H

### MORE INFO:

Qty: TBD

Double Sided

Price: \$5,500

Verify graphic size before printing.

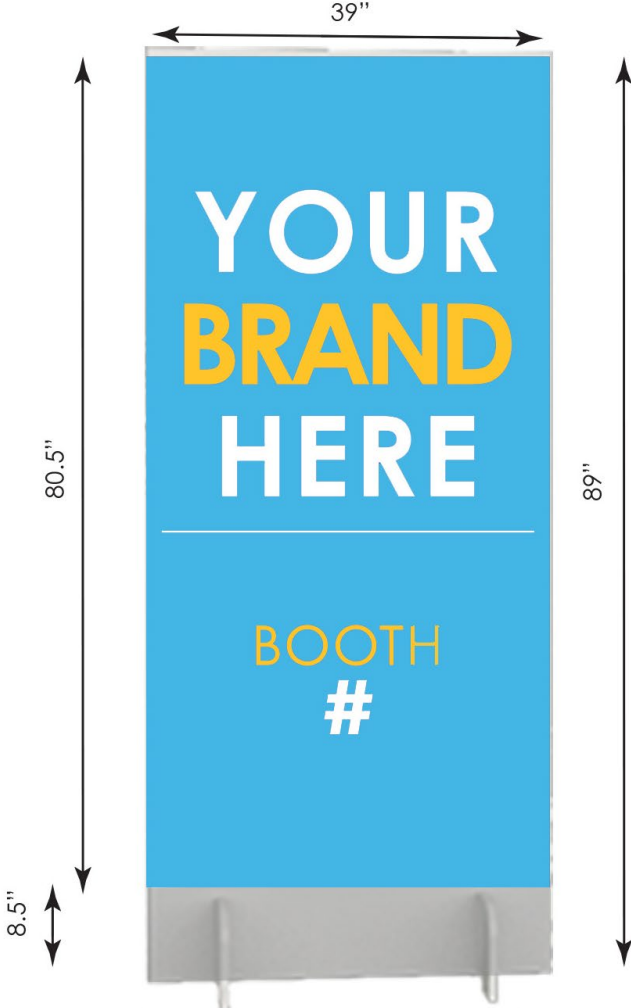

Anything in the dark gray areas will be cut or hidden. Anything in the white-striped area may be hidden from view depending on the angle of view. Please keep these areas clear of anything but background art. No logos or copy.

# Exhibit Hall

## AS-1 | Aisle Sign Danglers

### SUGGESTED MATERIAL:

3/16" Foam

### SUGGESTED SIZE:

Custom shape not to exceed 48"W and 24"H

### MORE INFO:

Qty: 1 per Aisle Sign

Double Sided

Price: \$2,000

Verify graphic size  
before printing.



# Spinning Kiosk

## SK-1 | Spinning Kiosk

### SUGGESTED MATERIAL:

3/16" Milk Plex

### SUGGESTED SIZE:

37-7/8"W x 92-13/16"H

### MORE INFO:

Qty: 6

Single Sided

**Price: \$10,000**

**Verify graphic size  
before printing.**

